



PMB600RM

0.6m Zone Marking Buoy

OVERVIEW

PMB600RM is an outstanding small-range buoy suitable for in shore/estuary locations. Consisting of 1 piece virgin MDPE, UV stable float sections filled with closed cell, water resistant polyurethane foam and built around an integral steel core incorporating one lifting and mooring eyes for optimum strength and reliability. Manufactured from virgin, UV stabilized MDPE offering strength and lightweight characteristics. The flexible design is adaptable to a wide range of Self-Contained Navigation Lights, internal Radar Reflector, and extra handles.

The buoys are built to last in extreme conditions. Even if the skin is punctured, the close cell foam filled polyethylene hull sections negate water absorption and keep it fully operational.

The range has been designed for ease of installation and transportation. They can be shipped and deployed or maintained quickly on-site.

The design of our Rotationally Moulded Polyethylene Buoys is meant to give customers the best of both worlds. They are lighter than steel, provide excellent performance, longevity and cost less. Maintenance is easy and a lower overall cost and a wide range of competitively priced accessories are available.

KEY FEATURES

- One piece float section
- Outstanding short-range buoy
- Excellent stability
- Does not require painting
- Low maintenance
- Wide range of Self-Contained navigation lights accepted
- It can be colored to suit IALA striped buoys

OPTIONAL FEATURES



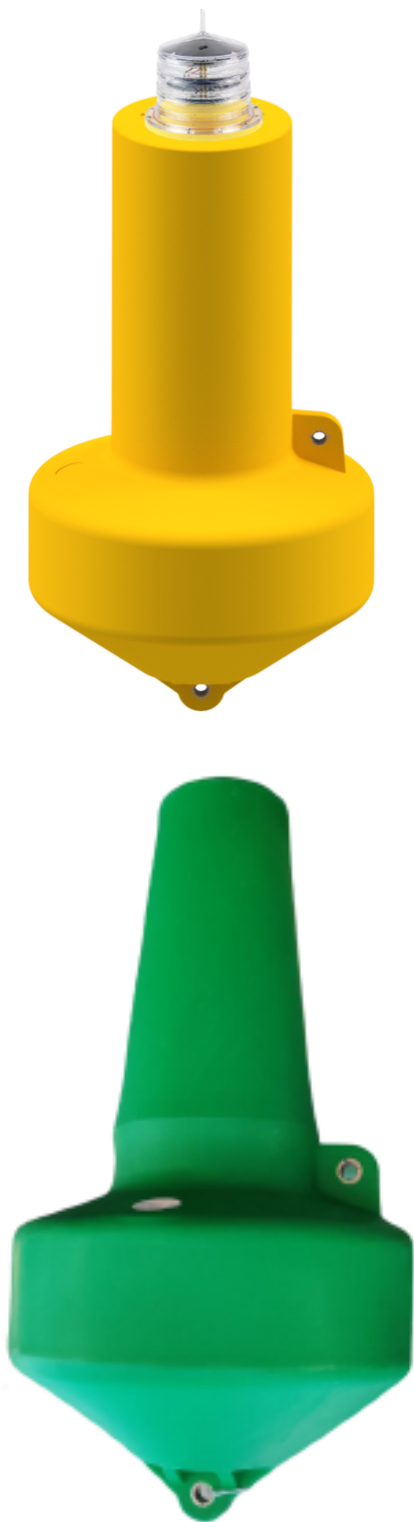

- Mould in Graphics
- Day marks
- Radar Reflection
- Mould-in Graphics Available
- Environmentally Friendly
- Recyclable

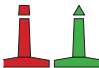

PHYSICAL SPECIFICATIONS	
Diameter (mm / inches)	550 / 22
Overall Weight (kg / lbs)	30 /66
Adjustable Ballast (kg / lbs)	15 / 33
Overall Height (mm / inches)	1050 / 41
Maximum Focal Plane Height (mm / inches)	700 / 26
Nominal Freeboard (mm / inches)	185 / 7.3
Nominal Draft (mm / inches)	260 / 10.23
Minimum Freeboard (mm / inches)	80 / 3.15
Maximum Draft (mm / inches)	360 / 14.17
Gross Buoyancy (kg / lbs)	75 / 165
Reserve Buoyancy (kg / lbs)	45 / 99
Submergence (kg / cm, lbs/ inch)	2.7 / 15
Visual Area (Without Day mark) (m ² / ft ²)	--
Visual Area (With Day mark – CAN Shape) (m ² / ft ²)	0.28 / 3
Visual Area (With Day mark – CON Shape) (m ² / ft ²)	0.25 / 2.7
Minimum Mooring Weight (kg / lbs)	N/A buoy is internally ballasted
Maximum Mooring Weight (kg / lbs) (To Maintain Minimum Freeboard)	27 / 59

Float	Rotationally moulded UV stabilized virgin polyethylene, MDPE, 7mm thick filled with closed cell polyurethane foam.
Super structure material	Rotationally moulded UV stabilized virgin polyethylene, MDPE
Mooring Assembly	316L Stainless Steel
Radar Reflector	Internal, Echomax (optional)
Colours	As specified per IALA recommendations

BUOY CONFIGURATIONS

Regulatory	Lateral	Special
		
		

A white cylindrical marker with orange bands and a diamond symbol, labeled "DANGER" and "OBSTRUCTION", sitting on a white base.

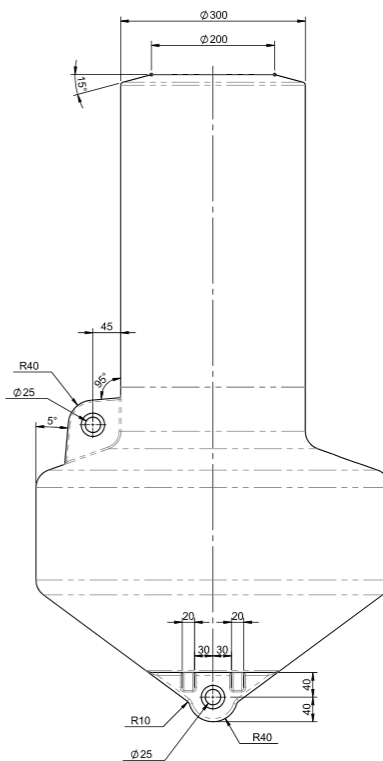
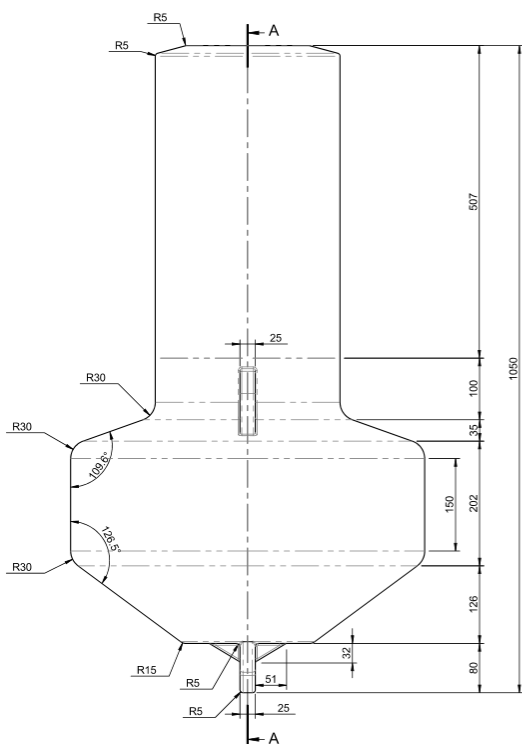

Pharos Marine Automatic Power
Gray, LA - USA
rleblanc@automaticpower.com
Phone: +1-985-223-8700

Pharos Marine Automatic Power, Ltd.
London, UK
sales@pharosmarine.com
Phone: +44-20-8538-

AB Pharos Marine Pte.
Singapore
sales@pharos-api.com
Phone: +65-6747-9325